



11 Piel View Grove

Barrow-In-Furness, LA13 0EF

Offers In The Region Of £199,950



2



1



2



D



11 Piel View Grove

Barrow-In-Furness, LA13 0EF

Offers In The Region Of £199,950



Nestled in the charming area of Piel View Grove, Barrow In Furness, this delightful detached bungalow offers a perfect blend of comfort and convenience. With two spacious reception rooms, this property provides ample space for relaxation and entertaining guests. The inviting layout is ideal for both quiet evenings at home and lively gatherings with family and friends. With its appealing features and prime location, this property is sure to attract interest. Do not miss the chance to make this charming bungalow your own.

Step into this delightful bungalow located in the heart of Roose, Barrow-in-Furness — a perfect blend of character, space, and comfort.

As you arrive, you're welcomed by a charming entrance porch that opens into a warm and inviting hallway, where beautiful wooden flooring sets a welcoming tone for the home. The flooring adds a touch of natural elegance and seamlessly guides you through the space.

To the front of the property, the lounge offers a cosy and homely atmosphere. Soft carpeting underfoot enhances the sense of comfort, while natural light floods the room, creating a bright and airy feel — ideal for relaxing or entertaining. Towards the rear of the bungalow, you'll find a spacious kitchen and dining area. This generous open-plan space provides plenty of room for both everyday living and hosting, with easy access to the large rear garden through a convenient back door — perfect for enjoying sunny afternoons or al fresco dining.

The property also boasts two large and well-proportioned bedrooms, both featuring laminated flooring and benefiting from excellent natural light, offering comfortable and versatile spaces for rest or work.

Completing the home is a traditional and characterful bathroom, thoughtfully designed with both a separate bath and shower, combining classic charm with practical modern living.

This bungalow offers a wonderful opportunity to enjoy single-storey living in a sought-after location, with plenty of space both inside and out.

Porch

Kitchen

17'0" x 12'3" (5.20 x 3.75)

Lounge

12'0" x 14'0" (3.66 x 4.27)

Bedroom 1

10'11" x 12'0" (3.33 x 3.66)

Bedroom 2

11'11" x 10'11" (3.65 x 3.34)

Bathroom

8'3" x 7'11" (2.54 x 2.43)



- Full of Character
- Versatile Garden Space
- Council Tax - B

- Popular and Welcoming Area
- Large Open Kitchen Plan
- EPC - D



Road Map

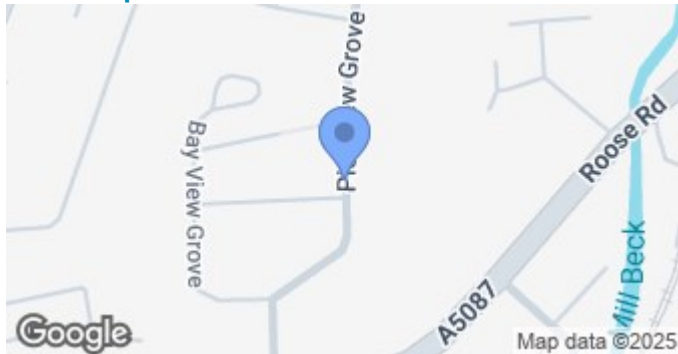

Terrain Map

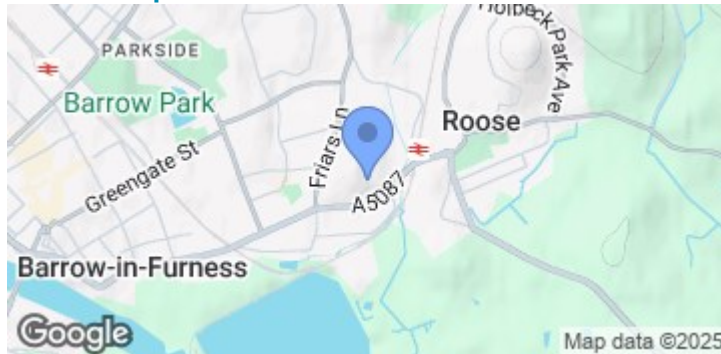

Floor Plan

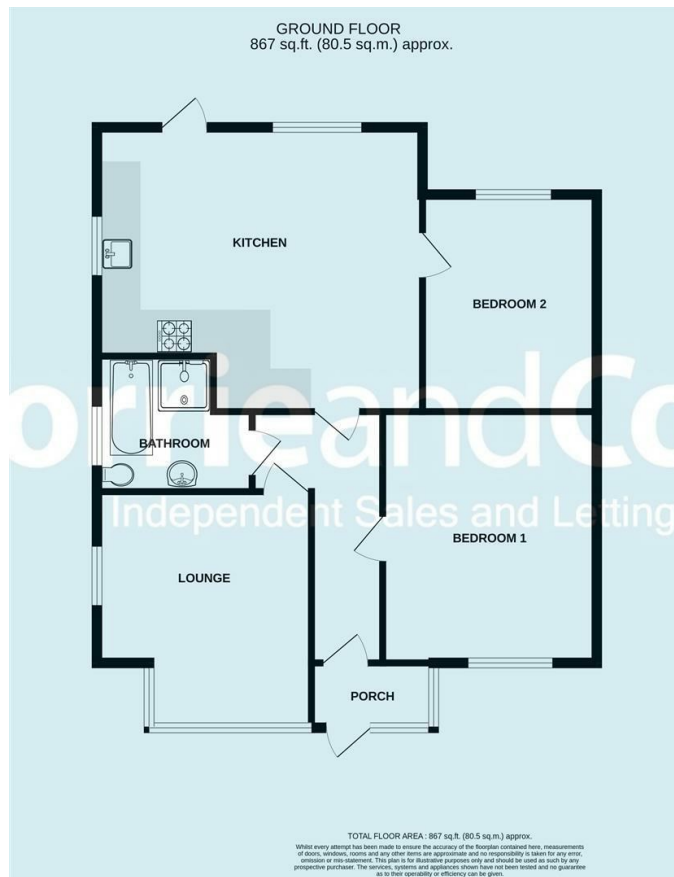

We are local, family run business who are wholly independent which means we can recommend services to most suit your needs. Our aim is to provide quality advice and expertise at all times, so you can make an informed decision whether buying or selling.

Estate agents are required by law to check a buyers /sellers identity to prevent Money Laundering and fraud. You do have to produce documents to prove your identity or address and information on your source of funds. Checking this information is a legal requirement to help safeguard your transaction, and failing to provide ID could cause delays. Corrie and Co, outsource these checks to speed up the process. The company does charge for such checks, please ask for more information and guidance on associated costs.

To ensure your move is stress free, we can help with Mortgage advice. We work alongside local Solicitors, offering competitive conveyancing services. Ask for further information.

